

**NOW AVAILABLE  
IN COBALT!**

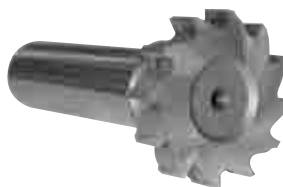

## WOODRUFF KEYSEAT CUTTERS SHANK TYPE - HIGH SPEED STEEL

All sizes have a uniform 1/2" diameter shank. Right hand cutters are standard. Left hand cutters are made to order with prices on application.

**HSS-K-600  
COBALT - KX-600**

**HSS-K-700  
COBALT - KX-700**

American Standard	Dia.	Width of Face	Overall Length
202	1/4	1/16	2 1/16
202 1/2	5/16	1/16	2 1/16
302 1/2	5/16	3/32	2 3/32
203	3/8	1/16	2 1/16
303	3/8	3/32	2 3/32
403	3/8	1/8	2 1/8
204	1/2	1/16	2 1/16
304	1/2	3/32	2 3/32
305	5/8	3/32	2 3/32
404	1/2	1/8	2 1/8
405	5/8	1/8	2 1/8
406	3/4	1/8	2 1/8
505	5/8	5/32	2 5/32
605	5/8	3/16	2 3/16
506	3/4	5/32	2 5/32
806	3/4	1/4	2 1/4
507	7/8	5/32	2 5/32
606	3/4	3/16	2 3/16
607	7/8	3/16	2 3/16
707	7/8	7/32	2 7/32
608	1	3/16	2 3/16
708	1	7/32	2 7/32
1208	1	3/8	2 3/8
609	1 1/8	3/16	2 3/16
807	7/8	1/4	2 1/4
808	1	1/4	2 1/4
709	1 1/8	7/32	2 7/32
809	1 1/8	1/4	2 1/4
610	1 1/4	3/16	2 3/16
710	1 1/4	7/32	2 7/32
810	1 1/4	1/4	2 1/4
811	1 3/8	1/4	2 1/4
812	1 1/2	1/4	2 1/4
1008	1	5/16	2 5/16
1009	1 1/8	5/16	2 5/16
1010	1 1/4	5/16	2 5/16
1011	1 3/8	5/16	2 5/16
1012	1 1/2	5/16	2 5/16
1210	1 1/4	3/8	2 3/8
1211	1 3/8	3/8	2 3/8
1212	1 1/2	3/8	2 3/8

Straight Tooth				Staggered Tooth			
HSS		COBALT		HSS		COBALT	
Catalog EDI-Number	List Price	Catalog EDI-Number	List Price	Catalog EDI-Number	List Price	Catalog EDI-Number	List Price
12301	\$19.50	35270	\$24.75	12342	\$21.50	35311	\$32.95
12302	19.50	35271	24.75	12343	21.50	35312	32.95
12303	19.50	35272	24.75	12344	21.50	35313	32.95
12304	19.50	35273	24.75	12345	21.50	35314	32.95
12305	19.50	35274	24.75	12346	21.50	35315	32.95
12306	19.50	35275	24.75	12347	21.50	35316	32.95
12307	19.50	35276	24.75	12348	21.50	35317	29.35
12308	19.50	35277	24.75	12349	21.50	35318	29.35
12309	19.50	35278	24.75	12350	21.50	35319	29.35
12310	19.50	35279	24.75	12351	21.50	35320	29.35
12311	19.50	35280	24.75	12352	21.50	35321	29.35
12312	21.20	35281	26.00	12353	23.75	35322	34.35
12313	19.50	35282	26.00	12354	21.50	35323	29.35
12314	19.50	35283	26.00	12355	21.50	35324	29.35
12315	21.20	35284	26.00	12356	23.75	35325	34.35
12316	21.20	35285	28.45	12357	23.75	35326	34.35
12317	23.65	35286	28.45	12358	26.45	35327	37.55
12318	21.20	35287	28.45	12359	26.45	35328	34.35
12319	23.65	35288	28.45	12360	26.45	35329	37.55
12320	23.65	35289	28.45	12361	26.45	35330	37.55
12321	26.45	35290	31.15	12362	29.40	35331	42.10
12322	26.45	35291	31.15	12363	29.40	35332	42.10
12323	27.50	35292	32.30	12364	31.60	35333	42.85
12324	29.40	35293	35.05	12365	32.35	35334	48.70
12325	23.75	35294	28.45	12366	26.45	35335	37.55
12326	26.45	35295	31.15	12367	29.40	35336	42.10
12327	29.40	35296	35.05	12368	32.35	35337	48.70
12328	29.40	35297	35.05	12369	32.35	35338	48.70
12329	32.20	35298	39.05	12370	35.85	35339	50.60
12330	32.20	35299	39.05	12371	35.85	35340	50.60
12331	32.20	35300	39.05	12372	35.85	35341	53.40
12332	34.65	35301	45.25	12373	39.10	35342	59.45
12333	38.00	35302	46.80	12374	42.45	35343	63.65
12334	27.15	35303	32.30	12375	30.10	35344	42.85
12335	31.30	35304	37.30	12376	34.15	35345	49.55
12336	33.95	35305	41.85	12377	37.05	35346	54.80
12337	37.80	35306	45.25	12378	41.90	35347	59.45
12338	39.00	35307	48.25	12379	41.15	35348	63.70
12339	33.95	35308	41.85	12380	36.95	35349	54.80
12340	37.80	35309	45.25	12381	41.90	35350	60.25
12341	39.80	35310	48.25	12382	45.45	35351	67.05

COATINGS AVAILABLE ON EVERY TOOL \*\* See Page 161 for details



# CARBIDE WOODRUFF KEYSEAT CUTTERS

## WOODRUFF KEYSEAT CUTTERS SHANK TYPE ~ CARBIDE TIPPED

All sizes have uniform 1/2" diameter shank. Right hand cutters are standard. Chip breakers are on all tools 5/32" wide and greater.

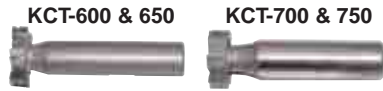

American Standard	Dia.	Width of Face	Overall Length	Number of Teeth	FOR STEEL							
					KCT-600 Straight Tooth		KCT-700 Staggered Tooth		KCT-650 Straight Tooth		KCT-750 Staggered Tooth	
					Catalog EDI-#	List Price	Catalog EDI-#	List Price	Catalog EDI-#	List Price	Catalog EDI-#	List Price
204	1/2	1/16	2 1/16	6	35200	\$99.80	35235	\$121.65	35200S	\$114.80	35235S	\$139.90
304	1/2	3/32	2 3/32	6	35201	99.80	35236	121.65	35201S	114.80	35236S	139.90
404	1/2	1/8	2 1/8	6	35202	99.80	35237	121.65	35202S	114.80	35237S	139.90
305	5/8	3/32	2 3/32	6	35203	103.35	35238	127.25	35203S	118.85	35238S	146.35
405	5/8	1/8	2 1/8	6	35204	103.35	35239	127.25	35204S	118.85	35239S	146.35
505	5/8	5/32	2 5/32	6	35205	103.35	35240	127.25	35205S	118.85	35240S	146.35
605	5/8	3/16	2 3/16	6	35206	103.35	35241	127.25	35206S	118.85	35241S	146.35
406	3/4	1/8	2 1/8	6	35207	107.90	35242	132.90	35207S	124.10	35242S	152.85
506	3/4	5/32	2 5/32	6	35208	107.90	35243	132.90	35208S	124.10	35243S	152.85
606	3/4	3/16	2 3/16	6	35209	107.90	35244	132.90	35209S	124.10	35244S	152.85
806	3/4	1/4	2 1/4	6	35210	107.90	35245	132.90	35210S	124.10	35245S	152.85
507	7/8	5/32	2 5/32	6	35211	112.95	35246	139.00	35211S	129.90	35246S	159.85
607	7/8	3/16	2 3/16	6	35212	112.95	35247	139.00	35212S	129.90	35247S	159.85
707	7/8	7/32	2 7/32	8	35213	112.95	35248	139.00	35213S	129.90	35248S	159.85
807	7/8	1/4	2 1/4	8	35214	112.95	35249	139.00	35214S	129.90	35249S	159.85
608	1	3/16	2 3/16	8	35215	127.40	35250	156.90	35215S	146.55	35250S	180.45
708	1	7/32	2 7/32	8	35216	127.40	35251	156.90	35216S	146.55	35251S	180.45
808	1	1/4	2 1/4	8	35217	127.40	35252	156.90	35217S	146.55	35252S	180.45
1008	1	5/16	2 5/16	8	35218	127.40	35253	156.90	35218S	146.55	35253S	180.45
1208	1	3/8	2 3/8	8	35219	127.40	35254	156.90	35219S	146.55	35254S	180.45
609	1 1/8	3/16	2 3/16	8	35220	133.95	35255	165.95	35220S	154.05	35255S	190.85
709	1 1/8	7/32	2 7/32	8	35221	133.95	35256	165.95	35221S	154.05	35256S	190.85
809	1 1/8	1/4	2 1/4	8	35222	133.95	35257	165.95	35222S	154.05	35257S	190.85
1009	1 1/8	5/16	2 5/16	8	35223	133.95	35258	165.95	35223S	154.05	35258S	190.85
610	1 1/4	3/16	2 3/16	8	35224	140.60	35259	173.10	35224S	161.70	35259S	199.10
710	1 1/4	7/32	2 7/32	8	35225	140.60	35260	173.10	35225S	161.70	35260S	199.10
810	1 1/4	1/4	2 1/4	8	35226	140.60	35261	173.10	35226S	161.70	35261S	199.10
1010	1 1/4	5/16	2 5/16	8	35227	140.60	35262	173.10	35227S	161.70	35262S	199.10
1210	1 1/4	3/8	2 3/8	8	35228	140.60	35263	173.10	35228S	161.70	35263S	199.10
811	1 3/8	1/4	2 1/4	8	35229	147.55	35264	181.70	35229S	169.70	35264S	208.95
1011	1 3/8	5/16	2 5/16	8	35230	147.55	35265	181.70	35230S	169.70	35265S	208.95
1211	1 3/8	3/8	2 3/8	8	35231	147.55	35266	181.70	35231S	169.70	35266S	208.95
812	1 1/2	1/4	2 1/4	8	35232	155.00	35267	193.45	35232S	178.25	35267S	222.50
1012	1 1/2	5/16	2 5/16	8	35233	155.00	35268	193.45	35233S	178.25	35268S	222.50
1212	1 1/2	3/8	2 3/8	8	35234	155.00	35269	193.45	35234S	178.25	35269S	222.50

## WOODRUFF KEYSEAT CUTTERS SHANK TYPE ~ SOLID CARBIDE

Solid Carbide construction, made with side cutting teeth.

+ .001-.002 tolerance on ODs, +.0005-.0005 tolerance on widths



KC-600

Catalog EDI-Number	Amer. Std.	Face Dia.	Width	OAL	No. of Flutes	List Price	Catalog EDI-Number	Amer. Std.	Face Dia.	Width	OAL	No. of Flutes	List Price
35353	203	3/8	1/16	2 1/4	6	\$112.50	35377	606	3/4	3/16	2 1/4	8	\$205.00
35355	303	3/8	3/32	2 1/4	6	116.25	35379	806	3/4	1/4	2 1/4	8	207.50
35357	403	3/8	1/8	2 1/4	6	117.50	35381	507	7/8	5/32	2 1/4	10	240.00
35359	204	1/2	1/16	2 1/4	8	137.50	35383	607	7/8	3/16	2 1/4	10	241.25
35361	304	1/2	3/32	2 1/4	8	138.75	35385	707	7/8	7/32	2 1/4	10	246.25
35363	404	1/2	1/8	2 1/4	8	140.00	35387	807	7/8	1/4	2 1/4	10	247.50
35365	305	5/8	3/32	2 1/4	8	162.50	35389	608	1	3/16	2 1/4	10	263.75
35367	405	5/8	1/8	2 1/4	8	163.75	35391	708	1	7/32	2 1/4	10	275.00
35369	505	5/8	5/32	2 1/4	8	165.00	35393	808	1	1/4	2 1/4	10	280.00
35371	605	5/8	3/16	2 1/4	8	167.50	35395	610	1 1/4	3/16	2 1/4	12	287.50
35373	406	3/4	1/8	2 1/4	8	200.00	35397	710	1 1/4	7/32	2 1/4	12	291.25
35375	506	3/4	5/32	2 1/4	8	202.50	35399	810	1 1/4	1/4	2 1/4	12	293.75

COATINGS AVAILABLE ON EVERY TOOL \*\* See Page 161 for details



Tel: (800) 338-6650 • Fax: (413) 289-1701 • www.fdtool.com



# T-SLOT – DOVETAIL CARBIDE TIPPED CUTTERS

## HEAVY DUTY COBALT ROUGHING T-SLOT CUTTERS

Catalog EDI-Number	Bolt Size	Cutter Dia.	Cutter Width	Overall Length	Shank Dia.	List Price
34920	1/2	31/32	25/64	3 7/16	3/4	\$117.05
34921	5/8	1 1/4	31/64	3 15/16	1	145.80
34922	3/4	1 15/32	5/8	4 7/16	1	183.75
34923	1	1 27/32	53/64	4 13/16	1 1/4	245.75
34924	1 1/4	2 7/32	1 3/32	5 3/8	1 1/4	319.60
34925	1 1/2	2 21/32	1 11/32	5 29/32	1 1/4	477.20



## CARBIDE TIPPED DOVETAIL CUTTERS



Catalog EDI-Number	Dia.	Width	Shank	Overall Length	Inc. Angle	List Price
12175	1/2	5/32	3/8	2 1/8	45°	\$128.10
12176	3/4	1/4	3/8	2 1/4	45°	138.60
12177	1	5/16	1/2	2 1/2	45°	148.10
12178	1 1/4	3/8	5/8	2 3/4	45°	168.25
12179	1 1/2	1/2	3/4	3 1/4	45°	188.20
12180	2	5/8	1	4 1/4	45°	238.15
12181	2 1/2	3/4	1 1/4	4 3/8	45°	308.10
12182	3	1	1 1/4	4 1/2	45°	379.60
12183	1/2	7/32	3/8	2 1/8	60°	128.10
12184	3/4	1/4	3/8	2 1/4	60°	138.60
12185	1	3/8	1/2	2 1/2	60°	148.10
12186	1 1/4	1/2	5/8	2 3/4	60°	168.25
12187	1 1/2	5/8	3/4	3 1/4	60°	188.20
12188	2	3/4	1	4 1/4	60°	238.15
12189	2 1/2	7/8	1 1/4	4 3/8	60°	308.10
12190	3	1 1/8	1 1/4	4 1/2	60°	379.60



## CARBIDE TIPPED T-SLOT CUTTERS

Bolt Size	Cutter Dia.	Cutter Width	Neck Dia.	Shank Dia.	Overall Length	Non-Ferrous/ Cast Iron EDI-#	List Price	Steel EDI-#	List Price
1/4	9/16	15/64	17/64	3/8	2 19/32	12191	\$112.95	12280	\$122.00
5/16	21/32	17/64	21/64	3/8	2 11/16	12192	116.70	12281	125.95
3/8	25/32	21/64	13/32	1/2	3 1/4	12193	149.95	12282	161.80
1/2	31/32	25/64	17/32	5/8	3 7/16	12194	161.10	12283	174.05
5/8	1 1/4	31/64	21/32	3/4	3 15/16	12195	211.35	12284	228.25
3/4	1 15/32	5/8	25/32	1	4 7/16	12196	236.05	12285	254.75
1	1 27/32	53/64	1 1/32	1 1/4	4 13/16	12197	321.15	12286	346.10
1 1/4	2 7/32	1 3/32	1 9/32	1 1/4	5 3/8	12198	414.75	12287	448.05
1 1/2	2 21/32	1 11/32	1 7/32	1 1/4	5 29/32	12199	499.15	12288	538.65



## CARBIDE TIPPED CHAMFERING CUTTERS

Angle	Tool Dia.	Shank Dia.	# of Teeth	Overall Length	Cutter Width	Non-Ferrous/ Cast Iron EDI-#	List Price	Steel EDI-#	List Price
45°	1/2	3/8	4	2 1/8	1/8	69901	\$128.85	69921	\$142.30
45°	3/4	3/8	6	2 1/8	3/16	69902	139.25	69922	153.40
45°	1	1/2	6	2 1/2	5/16	69903	149.60	69923	164.65
45°	1 1/2	3/4	8	2 3/4	1/2	69904	188.90	69924	208.05
60°	1/2	3/8	4	2 1/8	7/32	69905	128.85	69925	142.30
60°	3/4	3/8	6	2 1/8	5/16	69906	139.25	69926	153.40
60°	1	1/2	6	2 1/2	7/16	69907	149.60	69927	164.65
60°	1 1/2	3/4	8	2 3/4	5/8	69908	188.90	69928	208.05

COATINGS AVAILABLE ON EVERY TOOL \*\* See Page 161 for details



Tel: (800) 338-6650 • Fax: (413) 289-1701 • www.fdtool.com

## T-SLOT CUTTERS HIGH SPEED STEEL

Regularly furnished right hand cut with staggered teeth.



**TAPER SHANK**

Catalog EDI-Number	Bolt Size	Cutter Dia.	Width	Neck Dia.	Overall Length	# B&S Shank	# of Teeth	List Price
14401-A1210	1/4	9/16	15/64	17/64	2 5/8	5	8	\$56.55
14402-A1212	5/16	21/32	17/64	21/64	2 23/32	5	8	60.90
14403-A1214	3/8	25/32	21/64	13/32	4 13/16	7	8	103.45
14404-A1216	1/2	31/32	25/64	17/32	5	7	8	114.20
14405-A1218	5/8	1 1/4	31/64	21/32	5 1/4	7	10	156.50
14406-A1220	3/4	1 15/32	5/8	25/32	6 7/8	9	10	176.05
14407-A1222	1	1 27/32	53/64	1 1/32	7 1/4	9	10	276.15
14408-A1224	1 1/4	2 7/32	1 3/32	1 9/32	7 13/16	9	12	348.90
14409-A1226	1 1/2	2 21/32	1 11/32	1 17/32	10 3/8	10	12	552.75

Catalog EDI-Number	Bolt Size	Cutter Dia.	Shank Dia.	Width	Neck Dia.	Overall Length	# of Teeth	List Price
14426-A1310	1/4	9/16	1/2	15/64	17/64	2 19/32	8	\$53.10
14427-A1312	5/16	21/32	1/2	17/64	21/64	2 11/16	8	57.35
14428-A1314	3/8	25/32	3/4	21/64	13/32	3 1/4	8	81.10
14429-A1316	1/2	31/32	3/4	25/64	17/32	3 7/16	8	92.10
14410-A1327	-	1	3/4	3/32	1/2	3 1/8	8	104.40
14411-A1328	-	1	3/4	1/8	1/2	3 1/8	8	107.30
14412-A1329	-	1	3/4	5/32	1/2	3 3/16	8	108.75
14413-A1330	-	1	3/4	3/16	1/2	3 3/16	8	110.40
14414-A1331	-	1	3/4	1/4	1/2	3 1/4	8	111.50
14415-A1332	-	1	3/4	5/16	1/2	3 5/16	8	113.30
14416-A1333	-	1	3/4	3/8	1/2	3 3/8	8	114.45
14417-A1334	-	1	3/4	1/2	1/2	3 1/2	8	114.45
14430-A1318	5/8	1 1/4	1	31/64	21/32	3 15/16	10	129.55
14431-A1320	3/4	1 15/32	1	5/8	25/32	4 7/16	10	147.05
14418-A1335	-	1 1/2	1	3/32	3/4	4 1/8	10	153.10
14419-A1336	-	1 1/2	1	1/8	3/4	4 1/8	10	153.10
14420-A1337	-	1 1/2	1	5/32	3/4	4 3/16	10	155.20
14421-A1338	-	1 1/2	1	3/16	3/4	4 3/16	10	156.75
14422-A1339	-	1 1/2	1	1/4	3/4	4 1/4	10	161.95
14423-A1340	-	1 1/2	1	5/16	3/4	4 5/16	10	161.95
14424-A1341	-	1 1/2	1	3/8	3/4	4 3/8	10	172.40
14425-A1342	-	1 1/2	1	1/2	3/4	4 1/2	10	172.40
14432-A1322	1	1 27/32	1 1/4	53/64	1 1/32	4 13/16	12	232.60
14435-A1343	-	2	1 1/4	3/32	1 1/8	4 1/2	12	250.10
14436-A1344	-	2	1 1/4	1/8	1 1/8	4 1/2	12	250.10
14437-A1345	-	2	1 1/4	5/32	1 1/8	4 9/16	12	254.30
14438-A1346	-	2	1 1/4	3/16	1 1/8	4 9/16	12	254.30
14439-A1347	-	2	1 1/4	1/4	1 1/8	4 5/8	12	278.50
14440-A1348	-	2	1 1/4	5/16	1 1/8	4 11/16	12	278.50
14441-A1349	-	2	1 1/4	3/8	1 1/8	4 3/4	12	287.80
14442-A1350	-	2	1 1/4	1/2	1 1/8	4 7/8	12	287.80
14433-A1324	1 1/4	2 7/32	1 1/4	1 3/32	1 9/32	5 3/8	12	308.70
14434-A1326	1 1/2	2 21/32	1 1/4	1 11/32	1 17/32	5 29/32	12	386.00



**STRAIGHT SHANK**

\* Sizes other than listed are special. If special sizes are needed, please call (800) 338-6650 for quote.

COATINGS AVAILABLE ON EVERY TOOL \*\* See Page 161 for details